

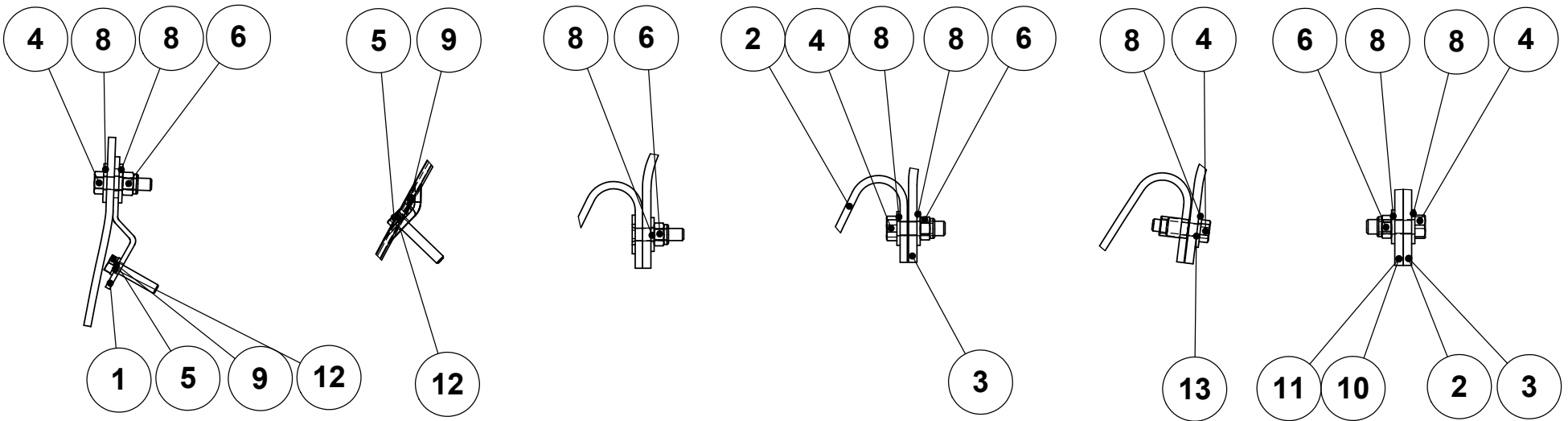

INSTALLATION PARTS LISTING - AIR FAIRING

(MACK)

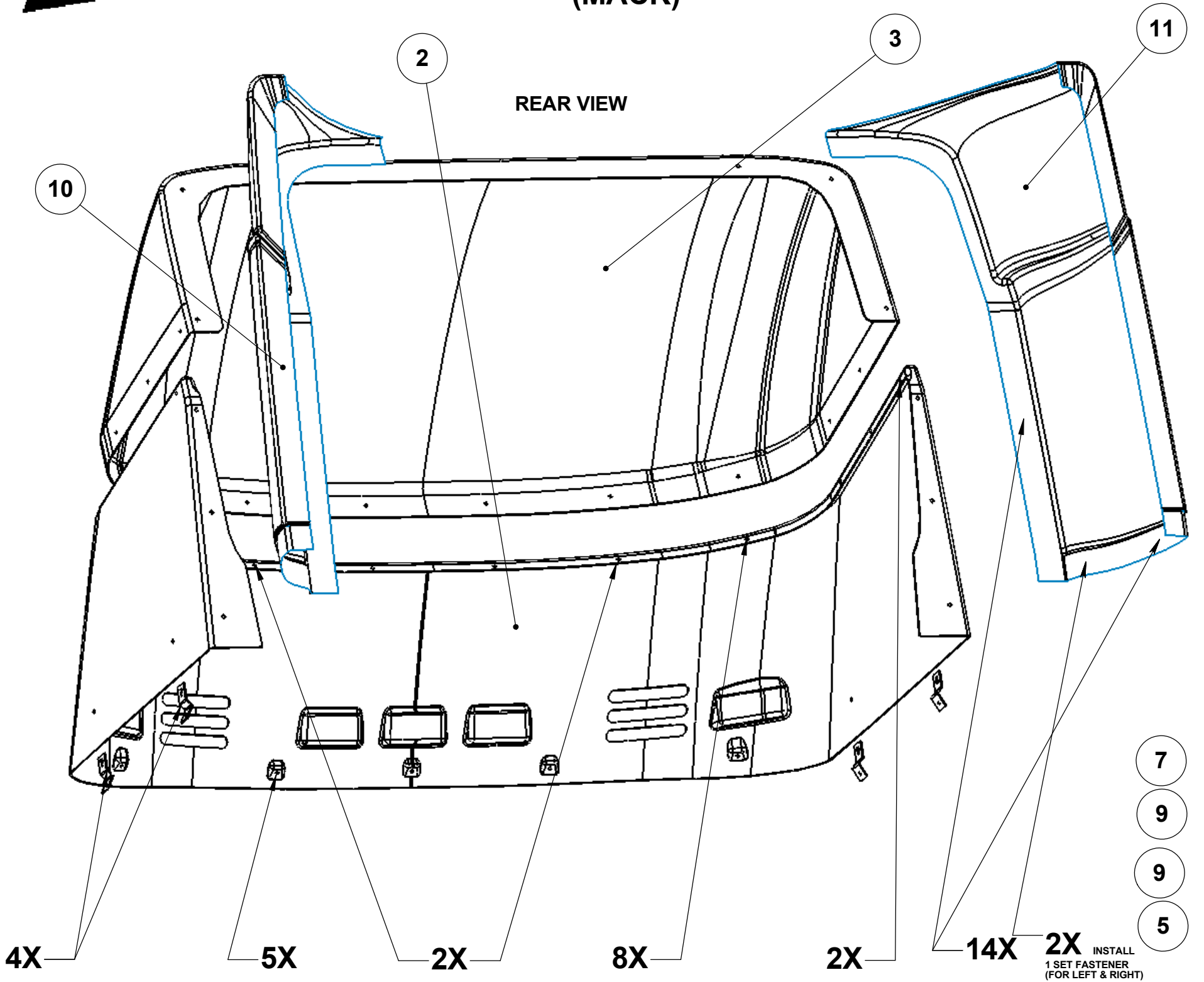

PART LISTING

RECOMMENDED TORQUE SPECS

BOLT SIZE	TORQUE (FT./LBS)	
	MIN	MAX
M8	20	25
M6	10	15

ITEM#	PART #	QTY.	DESCRIPTION
1	BK504	4	BRACKET
2	MCFB200	1	BOTTOM FAIRING
3	MCFT200	1	TOP FAIRING
4	SC201	28	SS HEX CAP SCREW M8X1.25X25
5	SC215	11	SS HEX CAP SCREW M6X1.0X30
6	NU201	28	SS NYLON INSERT HEX NUT M8X1.25
7	NU207	2	SS NYLON INSERT HEX NUT M6X1.0
8	WA201	56	SS FENDER WASHER M8
9	WA217	13	SS FENDER WASHER M6
10	MCTL205	1	LEFT TRIM TAB
11	MCTR205	1	RIGHT TRIM TAB
12	WA 218	9	RUBBER WASHER SELFSTICK
13	WA205	2	SS M8 SPLIT WASHER



Laydon Composites Ltd.
2109 Wyecroft Rd.
Oakville, ON, L6L 5L7
CANADA

Tel: (905)829-9200
Fax: (905)829-9701



MACK ASSEMBLY INSTRUCTIONS

6 EASY STEPS FOR ASSEMBLING THE **LCL** AIR FAIRING

1	The air fairing will arrive with the top installed upside down fastened at four attachment points. The hardware bag will be attached to one of the front attachment points and if a long air fairing, the two trim tabs will be nested in the top by shrink-wrap.
2	Remove packaging to free the trim tabs, if you have a long air fairing.
3	Remove fasteners at the four attachment points, keep the fasteners (2 bolts, 2 lock nuts, 2 split washers and 4 flat washers) you will need to reuse them. The hardware bag is now free. Hold the top carefully and release it from the front two permanent studs. If the unit is a short air fairing there will be one hardware kit entitled Dealer Bag MCHD200. If it is a long air fairing there will be a second hardware kit entitled Side Trim Tab MCHT205; both bags will be in one large bag.
4	Flip the top upright and reattach it to the front two studs and secure the two rear attachment points into the rivnuts, using the original fasteners. The top is now supported. DO NOT TIGHTEN THE FASTENERS AT THIS TIME.
5	Using the fasteners from the MCHD200 bag, fasten the remaining 8 points using a bolt, two washers and a locknut. Place the bolts with the head behind the flange so that the locknut is attached on the inner side and visible. The holes are slotted to give you flexibility in aligning the holes of the top to the bottom. Please note that one extra fastener is provided in this bag. AGAIN, DO NOT TIGHTEN THE FASTENERS.
6	If you are installing a short air fairing, once all the fasteners have been loosely installed, you may tighten them up. Start from the center and move outwards. If you are installing a long air fairing, leave the fasteners loose and proceed to install the trim tabs. If the trim tabs do not immediately line-up to the top, bottom and side shields, loosen the five front and the twelve rear bracket attachments points to the cab. All holes are slotted to allow you to shift the air fairing to align all the holes. Once aligned, complete the fastener attachment of the trim tabs and keep them loose until all points of attachment have fasteners. Once this is complete, you can tighten all fasteners. Complete install of side trim tabs using M6X30 bolts and a washer on each side of the fiberglass parts. Use hole on side extender as drilling template. DON'T FORGET TO RETIGHTEN THE CAB FASTENERS.

LAYDON COMPOSITES LTD. (905) 829-9200



Laydon Composites Ltd.
2109 Wycroft Rd.
Oakville, ON, L6L 5L7
CANADA

Tel: (905)829-9200
Fax: (905)829-9701



INSTALLATION PARTS LISTING - AIR FAIRING (FOR DEALER)

(MACK)

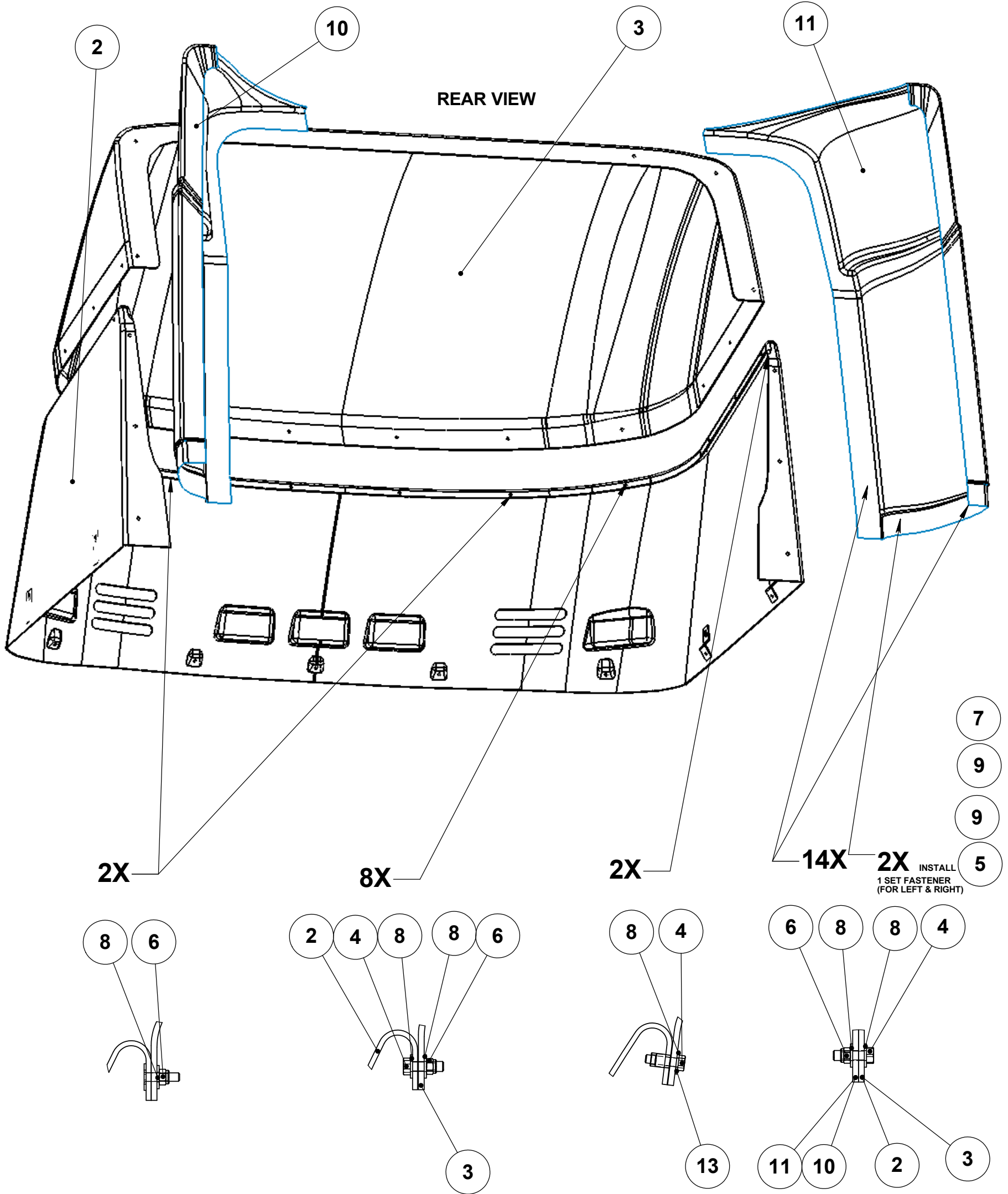

RECOMMENDED TORQUE SPECS

BOLT SIZE	TORQUE (FT./LBS)	
	MIN	MAX
M8	20	25
M6	10	15

PART LISTING

ITEM#	PART #	QTY.	DESCRIPTION
2	MCFB200	1	BOTTOM FAIRING
3	MCFT200	1	TOP FAIRING
4	SC201	24	SS HEX CAP SCREW M8X1.25X25
5	SC215	2	SS HEX CAP SCREW M6X1.0X30
6	NU201	24	SS NYLON INSERT HEX NUT M8X1.25
7	NU207	2	SS NYLON INSERT HEX NUT M6X1.0
8	WA201	48	SS FENDER WASHER M8
9	WA217	4	SS FENDER WASHER M6
10	MCTL205	1	LEFT TRIM TAB
11	MCTR205	1	RIGHT TRIM TAB
13	WA205	2	SS M8 SPLIT WASHER



Laydon Composite LTD.
2109 Wycroft Rd.
Oakville, ON, L6L 5L7
CANADA

Tel: (905)829-9200
Fax: (905)829-9701