

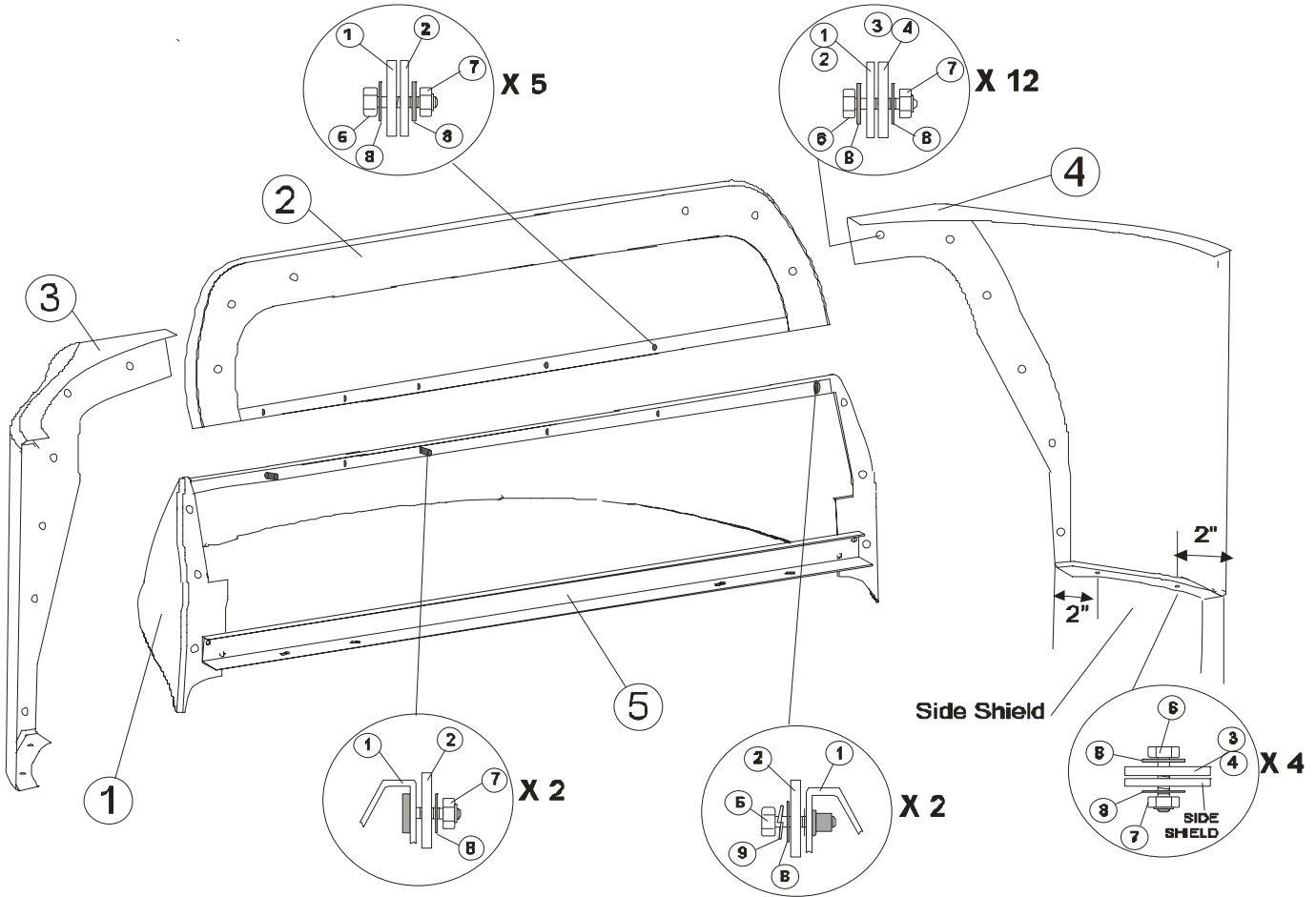

DEALER INSTALLATION FASTENER LISTING - AIR FAIRING #LD8600

TRUCK MANUFACTURER:
VEHICLE TYPE:
SLEEPER/CAB SIZE:

NAVISTAR
CONVENTIONAL
8600 DAYCAB



PARTS LISTING

ITEM. NO:	DESCRIPTION	PART #	QTY
1	FAIRING BOTTOM	IN FB 280	1
2	FAIRING UPPER	IN FT 200	1
3	LEFT TRIM TAB	IN TL 285 (OPTIONAL)	1
4	RIGHT TRIM TAB	IN TR 285 (OPTIONAL)	1
5	CROSS BAR	IN BB 300	1
6	BOLT M8 x 25, SS	SC 201	23 *
7	LOCKNUT M8, SS	NU 201	23 *
8	FENDER WASHER 8mm I.D., SS	WA 201	46 *
9	LOCK WASHER, 8mm I.D., SS	WA 205	2 *

RECOMMENDED TORQUE SPECS

BOLT SIZE	TORQUE [ft.lbs]	
	MIN	MAX
1/4" BOLTS	10	15
5/16" BOLTS	20	25
M8 BOLTS	20	25
3/8" BOLTS	30	35

* NOTE: REUSE FASTENERS PROVIDED FOR SHIPPING

ORDERING AND CUSTOMER SUPPORT:

Laydon Composites Ltd.
2109 WYECROFT RD.
Oakville, ON, L6L 5L7
Canada

TEL: 905-829-9200
FAX: 905-829-9701

Mar 11, 2005 - Rev 5 - SUPERSEDES ALL PREVIOUS VERSIONS, Property of LCL



DEALER INSTALLATION INSTRUCTIONS - LD8600 & LD9100

1. Remove trim tabs and packaging from fairing assembly. Remove M8 locknuts, washers and packaged fasteners from stud plates located at the front of the lower/upper fairing assembly. Remove both M8 bolts from the rear corners of the lower/upper fairing assembly.
2. Remove the upper fairing from the lower fairing. Invert the upper fairing and assemble the two 3/8" slotted holes onto the two stud plates located near the center of the lower fairing. Adjust the upper fairing until the two rear most holes line up with the two rivnuts of the lower fairing. Refasten one M8x25, 8mm lockwasher and 8mm fender washer to each rivnut.

NOTE: DO NOT TIGHTEN ANY FASTENERS UNTIL ALL ATTACHMENTS HAVE BEEN MADE

3. Refasten M8 locknuts and 8mm fender washers to the two stud plates as shown below
4. Fasten M8x25 bolts, 8mm fender washers and M8 locknuts to the five remaining mounting holes in the lower fairing as shown below.

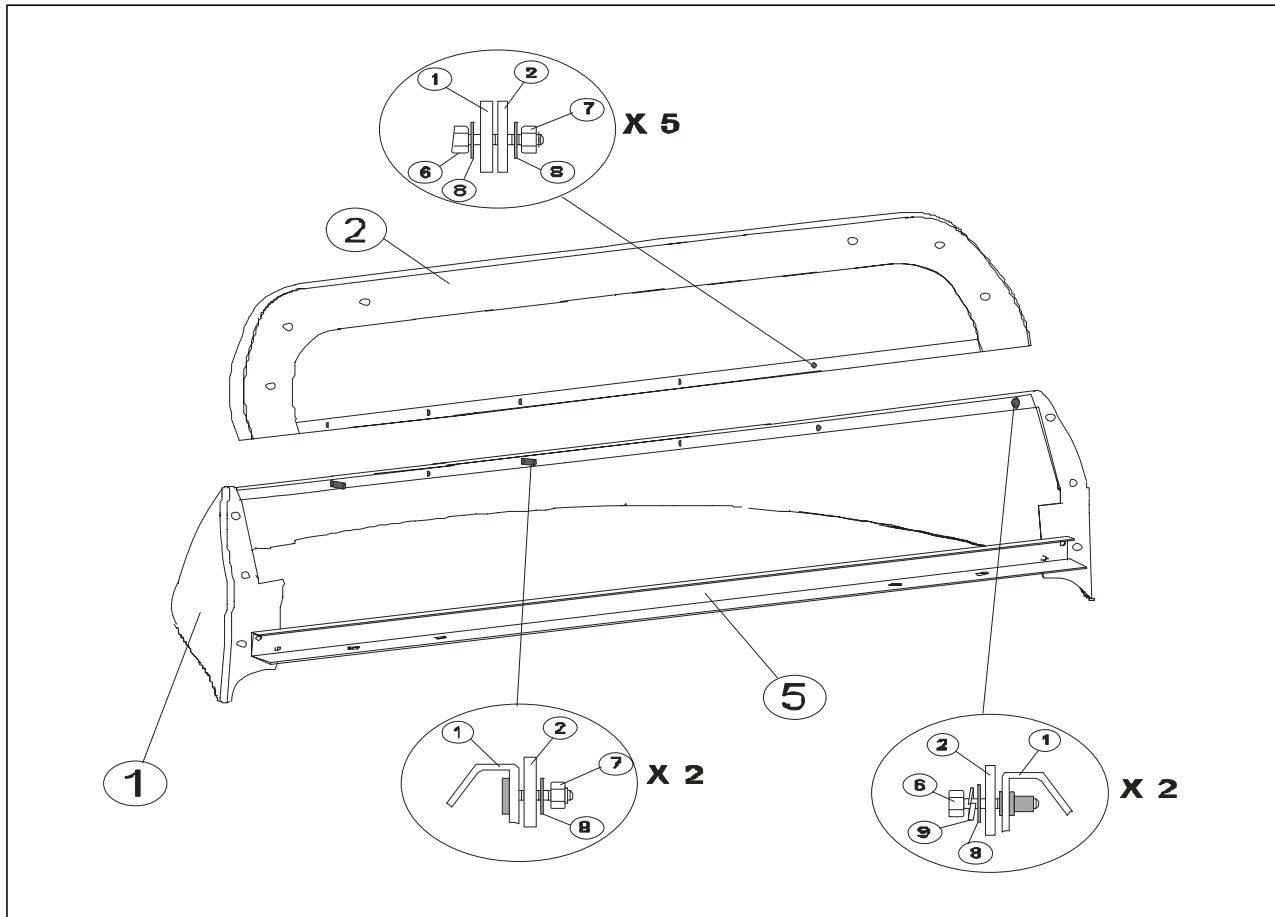

PARTS LISTING

ITEM. NO:	DESCRIPTION	PART #	QTY
1	FAIRING BOTTOM	IN FB 280	1
2	FAIRING UPPER	IN FT 200	1
5	CROSS BAR	IN BB 300	1
6	BOLT M8 x 25, SS	SC 201	7 *
7	LOCKNUT M8, SS	NU 201	7 *
8	FENDER WASHER 8mm I.D., SS	WA 201	14 *
9	LOCK WASHER, 8mm I.D., SS	WA 205	2 *

RECOMMENDED TORQUE SPECS

BOLT SIZE	TORQUE [ft.lbs]	
	MIN	MAX
1/4" BOLTS	10	15
5/16" BOLTS	20	25
M8 BOLTS	20	25
3/8" BOLTS	30	35

* NOTE: REUSE FASTENERS PROVIDED FOR SHIPPING



DEALER INSTALLATION INSTRUCTIONS - LD8600 & LD9100

5. Fasten each trim tab to the upper and lower fairing mounting holes using M8x25 bolts, 8mm fender washers and M8 locknuts as shown below.
6. Position and clamp each trim tab to its corresponding side shield. For LD8600 models drill a 5/16" hole thru the Trim tab and side shield 2.00" from the inner and outer edges.
7. Fasten side shields to trim tabs using M8x25 bolts, 8mm fender washers and M8 locknuts, as shown.
8. Tighten trim tabs to upper/lower fairing bolts first. Tighten trim tabs to side shields. Tighten upper to lower assembly. If gaps develop loosen fasteners and readjust components (holes are elongated for this purpose), then retighten.
9. Tighten all connections to the proper torque.

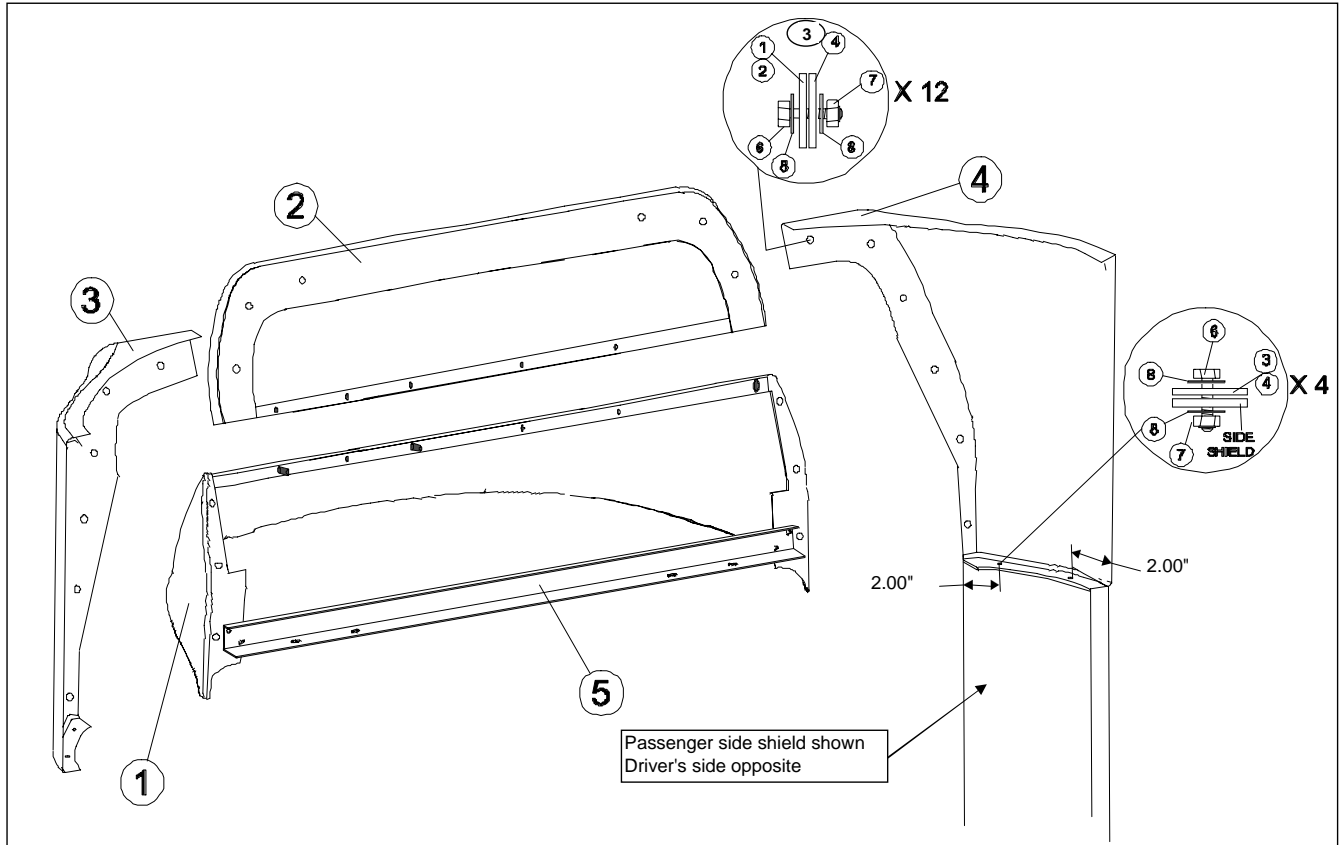

PARTS LISTING

ITEM. NO:	DESCRIPTION	PART #	QTY
1	FAIRING BOTTOM	IN FB 280	1
2	FAIRING UPPER	IN FT 200	1
3	LEFT TRIM TAB	IN TL 285	1
4	RIGHT TRIM TAB	IN TR 285	1
5	CROSS BAR	IN BB 300	1
6	BOLT M8 x 25, SS	SC 201	16
7	LOCKNUT M8, SS	NU 201	16
8	FENDER WASHER 8mm I.D., SS	WA 201	32

RECOMMENDED TORQUE SPECS

BOLT SIZE	TORQUE [ft.lbs]	
	MIN	MAX
1/4" BOLTS	10	15
5/16" BOLTS	20	25
M8 BOLTS	20	25
3/8" BOLTS	30	35