

# LCL KW AF 300 (R33-1050) Assembly Instructions

## Bulk Shipped Components - Prep Center Installation

1. On the shop floor place bottom fairing (KW FB 200)
2. Place 9ft. of shrinkwrap across the lower fairing from front to back, such that the end of the shrink wrap is about 6" to 8" in front of the front face.
3. Allow the shrinkwrap to follow the contour of the fairing bottom. Then pierce the shrink wrap at the two M8 stud plates.
4. Place the upper fairing upside down (gelcoat side facing the floor) and align the two 10mm diameter slotted holes onto the two stud plates.

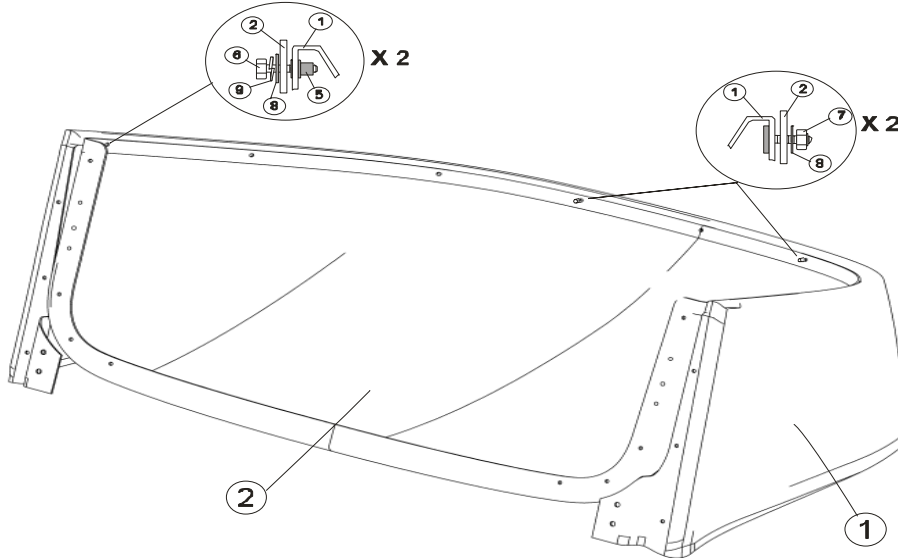

5. Lower the upper fairing towards the floor, stopping when the upper extreme right and left mounting holes line up with the two rivnuts located at the upper corners of the lower fairing.
6. Install one M8 x 25, 8mm lockwasher and 8mm fender washer into each AVK rivnut.
7. Install the Dealer hardware kit(s) onto one of the stud plates. Install one 8mm fender washer and M8 locknut onto each stud plate.
8. Place each foam wrapped trim tab (extra foam at tab ends)(KW TL 200, KW TR 200) into the cavity of the upper fairing.  
Note: Separate each trim tab with corrugated cardboard (to avoid chaffing during transport). Also place a corrugated cardboard section over the top trim tab.

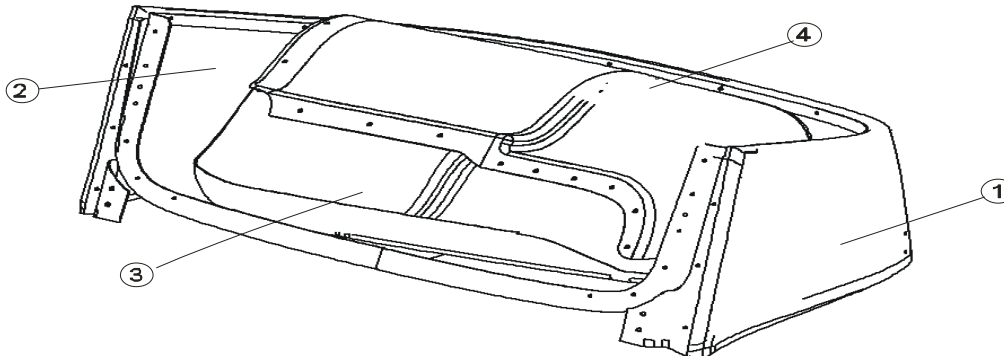

9. Pull each end to the shrinkwrap over the nested fairing (a small piece of tape will hold the two ends).
10. Using a shrinkfast torch join the ends of the shrink wrap together (avoid excessive heat to the upper most trim tab). Continue shrinking the film, underside as well, until a tight package is formed. (do not burn holes into the package)

| ITEM. NO: | DESCRIPTION                  | PART #    | QTY |
|-----------|------------------------------|-----------|-----|
| 1         | FAIRING BOTTOM               | KW FB 200 | 1   |
| 2         | FAIRING UPPER                | KW FT 200 | 1   |
| 3         | LEFT TRIM TAB                | KW TL 200 | 1   |
| 4         | RIGHT TRIM TAB               | KW TR 200 | 1   |
| 6         | BOLT M8x1.25 x 25mm, SS Hex  | SC 201    | 2   |
| 7         | LOCKNUT M8x1.25, SS Hex      | NU 201    | 2   |
| 8         | FENDER WASHER 8mm I.D., SS   | WA 201    | 4   |
| 9         | LOCK WASHER, 8mm I.D., SS    | WA 205    | 2   |
| 10        | Dealer Hardware kit          | KW HD 200 | 1   |
| 11        | Dealer Trim Tab Hardware Kit | KW HT 205 | 1   |

| BOLT SIZE   | TORQUE [ft.lbs] |     |
|-------------|-----------------|-----|
|             | MIN             | MAX |
| 1/4" BOLTS  | 10              | 15  |
| 5/16" BOLTS | 20              | 25  |
| M8 BOLTS    | 20              | 25  |
| 3/8" BOLTS  | 30              | 35  |

Note: Item # 10 & 11 may be contained in one plastic bag

**Prep Center Installation**

See "Prep Center Installation Fastener listing" document

1. Place shrink wrapped fairing unit onto cab roof, such that the mounting brackets are against the inside of the lower fairing.
2. Fasten the four holes using fasteners listed below.
3. Fasten the four rear holes to the rear mounting brackets using the fasteners listed below.
4. Tighten all bolts to the specified torque listed below.
5. Ensure the plastic shrinkwrap and fasteners of the top/bottom/trim tab assembly are secure.

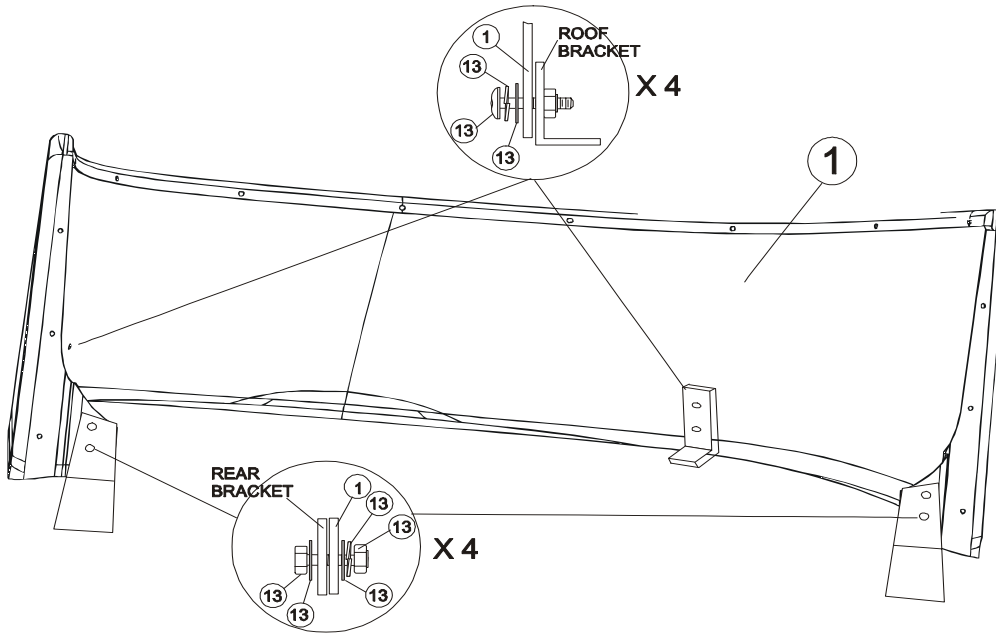

**PARTS LISTING**

| ITEM. NO: | DESCRIPTION                   | PART #    | QTY |
|-----------|-------------------------------|-----------|-----|
| 1         | FAIRING BOTTOM                | KW FB 200 | 1   |
| 13        | Hardware supplied by Kenworth |           |     |

**RECOMMENDED TORQUE SPECS**

| BOLT SIZE   | TORQUE [ft.lbs] |     |
|-------------|-----------------|-----|
|             | MIN             | MAX |
| 1/4" BOLTS  | 10              | 15  |
| 5/16" BOLTS | 20              | 25  |
| M8 BOLTS    | 20              | 25  |
| 3/8" BOLTS  | 30              | 35  |

# PREP CENTER INSTALLATION FASTENER LISTING - AIR FAIRING #KW AF 300

TRUCK MANUFACTURER:  
VEHICLE TYPE:  
SLEEPER/CAB SIZE:

KENWORTH  
CONVENTIONAL  
T800 / R33-1050

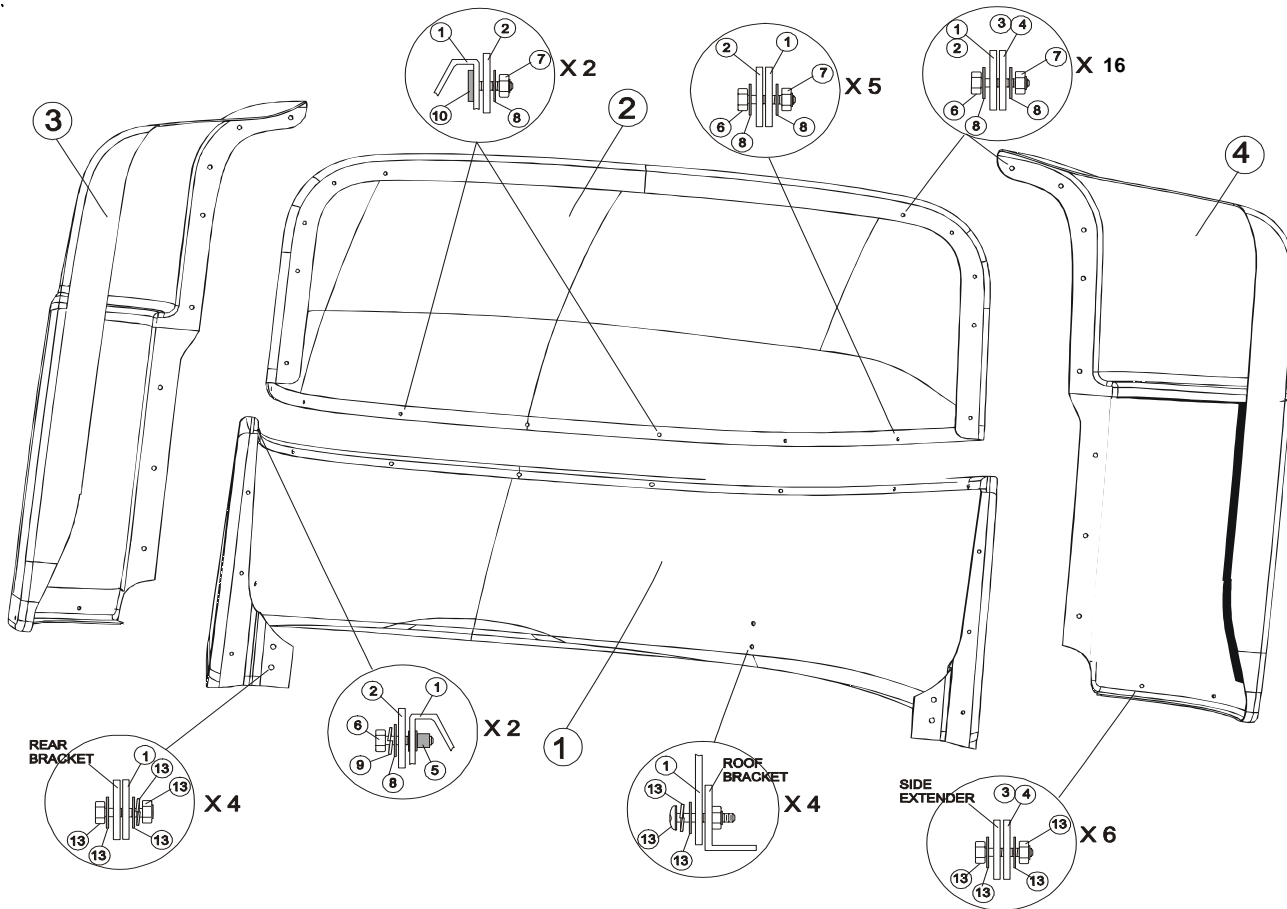

## PARTS LISTING

| ITEM NO: | DESCRIPTION                   | PART #    | QTY |
|----------|-------------------------------|-----------|-----|
| 1        | FAIRING BOTTOM                | KW FB 200 | 1   |
| 2        | FAIRING UPPER                 | KW FT 200 | 1   |
| 3        | LEFT TRIM TAB                 | KW TL 200 | 1   |
| 4        | RIGHT TRIM TAB                | KW TR 200 | 1   |
| 6        | BOLT M8x1.25 x 25mm, SS Hex   | SC 201    | 29  |
| 7        | LOCKNUT M8x1.25, SS Hex       | NU 201    | 29  |
| 8        | FENDER WASHER 8mm I.D., SS    | WA 201    | 58  |
| 9        | LOCK WASHER, 8mm I.D., SS     | WA 205    | 2   |
| 13       | Hardware supplied by Kenworth |           |     |

## RECOMMENDED TORQUE SPECS

| BOLT SIZE   | TORQUE [ft.lbs] |     |
|-------------|-----------------|-----|
|             | MIN             | MAX |
| 1/4" BOLTS  | 10              | 15  |
| 5/16" BOLTS | 20              | 25  |
| M8 BOLTS    | 20              | 25  |
| 3/8" BOLTS  | 30              | 35  |

## ORDERING AND CUSTOMER SUPPORT:

Laydon Composites Ltd.  
2109 Wyecroft Rd.  
Oakville, ON, L6L 5L7  
Canada

TEL: 905-829-9200  
FAX: 905-829-9701

LCL - ENG - 043

December 23, 2004 REV 3.0 supersedes all other versions, Property of LCL

TRUCK MANUFACTURER: KENWORTH  
 VEHICLE TYPE: CONVENTIONAL  
 SLEEPER/CAB SIZE: T800 / R33-1050

1. Remove shrink wrap packaging. Remove trim tabs from cavity of upper fairing.
2. Remove nylon inset nuts at front stud plates of upper fairing. Remove hardware bag.
3. Remove M8 hex bolts from rear mounting area of upper/lower fairing. Remove upper fairing from lower fairing. Discard metal lifting brackets at front stud plates.
4. Invert upper fairing and the two slotted holes of the upper fairing onto the two lower fairing stud plates. Install one M8x25mm hex bolt, M8 lock washer and M8 fender washer into the two M8 rivnuts located at the upper rear edge of the lower fairing. Do not tighten at this point.
5. Install one M8 locknut and M8 fender washer onto each stud plate, hand tight.
6. Install one M8x25mm hex bolt, two M8 fender washers and one M8 locknut into each remaining hole of the upper and lower fairing joint. Hand tighten.
7. Install the left trim tab behind the side extender such that the smooth surface of the trim tab is touching the side extender. Install one M8x25mm hex bolt, two M8 fender washers and one M8 locknut into each hole joining the trim tab to the upper and lower fairing. Do not tighten.
8. Repeat step 7 for the right trim tab.
9. Starting with the middle of the upper/lower fairing joint tighten each bolt to 20 to 25ft.lbs of torque. Tighten each bolt working towards the rear of the fairing. Then tighten the remaining bolts of both trim tabs.
10. Using the three holes in the lower left trim tab (near the left side extender) as a template, drill 9.5mm holes through the side extender.
11. Install one M8x25mm hex bolt, two M8 fender washers and one M8 locknut into each hole in the left trim tab. Tighten to 20 to 25 ft.lbs.
12. Repeat steps 10 and 11 for the right trim tab.

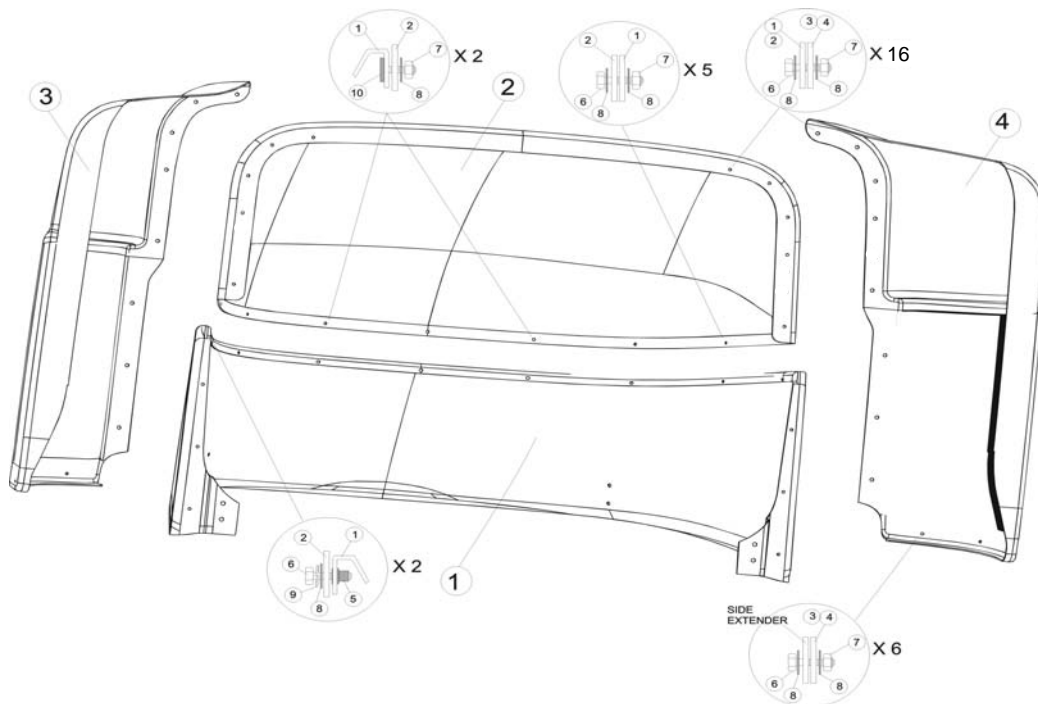

**PARTS LISTING**

| ITEM NO: | DESCRIPTION                 | PART #    | QTY |
|----------|-----------------------------|-----------|-----|
| 1        | FAIRING BOTTOM              | KW FB 200 | 1   |
| 2        | FAIRING UPPER               | KW FT 200 | 1   |
| 3        | LEFT TRIM TAB               | KW TL 200 | 1   |
| 4        | RIGHT TRIM TAB              | KW TR 200 | 1   |
| 5        | M8x1.25 AVK rivnut          | RN 201    | 2   |
| 6        | BOLT M8x1.25 x 25mm, SS Hex | SC 201    | 29  |
| 7        | LOCKNUT M8x1.25, SS Hex     | NU 201    | 29  |
| 8        | FENDER WASHER 8mm I.D., SS  | WA 201    | 58  |
| 9        | LOCK WASHER, 8mm I.D., SS   | WA 205    | 2   |
| 10       | M8x1.25 x35mm stud plate    | SP 200    | 2   |

**RECOMMENDED TORQUE SPECS**

| BOLT SIZE   | TORQUE [ft.lbs] |     |
|-------------|-----------------|-----|
|             | MIN             | MAX |
| 1/4" BOLTS  | 10              | 15  |
| 5/16" BOLTS | 20              | 25  |
| M8 BOLTS    | 20              | 25  |
| 3/8" BOLTS  | 30              | 35  |

**ORDERING AND CUSTOMER SUPPORT:**

Laydon Composites Ltd. TEL: 905-829-9200  
 2109 Wyecroft Rd. FAX: 905-829-9701  
 Oakville, ON, L6L 5L7  
 Canada