

# **LCL** KW AF 350 (R33-1092) Assembly Instructions **Extended Cab Version**

## Bulk Shipped Components - Prep Center Installation

1. On the shop floor place bottom fairing (KW FB 250)
2. Install disposable spacers along the inner mounting surface of the fairing bottom.  
Begin with the M8 rivnut, installing an M8x25, 8mm lock washer, 8mm fender washer.  
Then add the M8x25 hex bolt, 8mm fender washer and M8x25 lock nut into the remaining two holes. Repeat for the other spacer.
3. Place 9ft. of shrink-wrap across the lower fairing from front to back, such that the end of the shrink-wrap is about 6" to 8" in front of the front face.
4. Place the upper fairing upside down (gel coat side facing the floor) and align the three 10mm diameter holes on each side with the holes in the spacers.

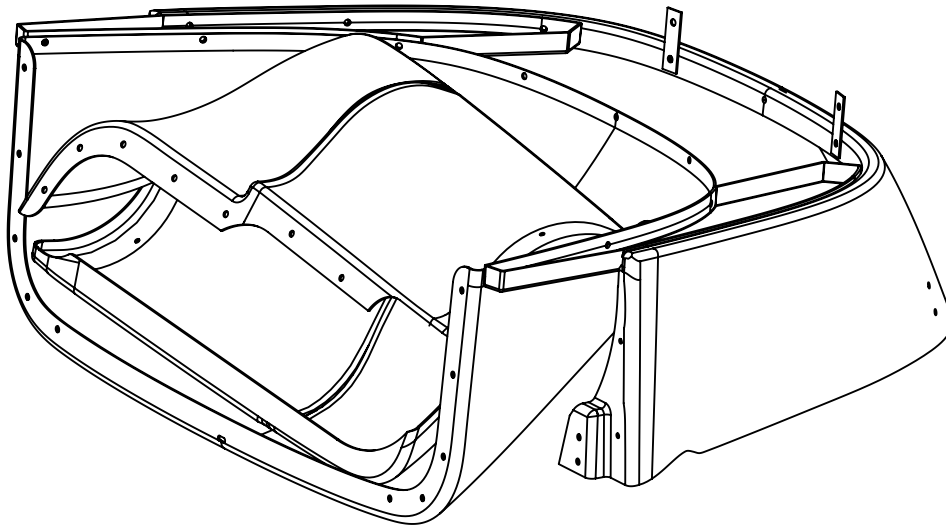

5. Install M8x25 hex bolts, 8mm Fender washers and M8x25 lock nuts into each hole.
6. Install lift plates onto front M8x25 stud plates. Install mounting hardware kit to stud plate.  
Secure with 8mm fender washer and M8x25 lock nuts to each stud plate.
7. Place each foam wrapped trim tab (extra foam at tab ends)(KW TL 250, KW TR 250) into the cavity of the upper fairing. Note: Separate each trim tab with corrugated cardboard (to avoid chaffing during transport). Also place a corrugated cardboard section over the top trim tab.

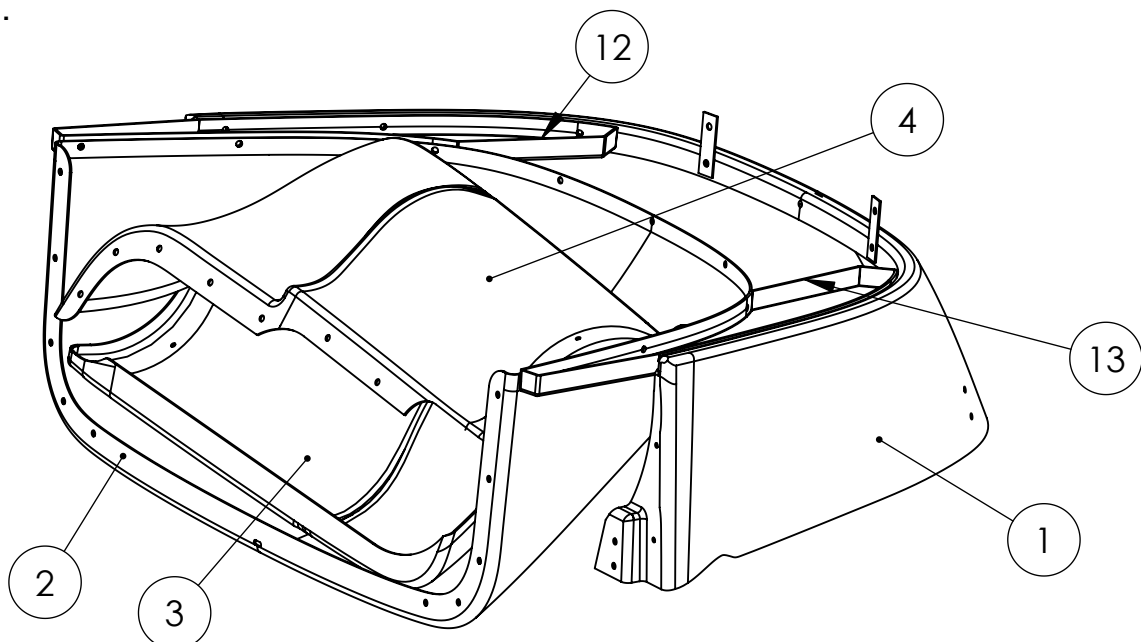

9. Pull each end to the shrink-wrap over the nested fairing (a small piece of tape will hold the two ends).
10. Using a shrink fast torch join the ends of the shrink-wrap together (avoid excessive heat to the upper most trim tab). Continue shrinking the film, underside as well, until a tight package is formed. (do not burn holes into the package).

ITEM #	DESCRIPTION	PART #	QUANTITY
1	FAIRING BOTTOM	KWFB250	1
2	FAIRING TOP	KWFT200	1
3	LEFT TRIM TAB	KWTL250	1
4	RIGHT TRIM TAB	KWTR250	1
6	BOLT M8X1.25X25mm,SS Hex	SC 201	12
7	LOCKNUT M8X1.25,SS Hex	NU 201	10
8	FENDER WASHER 8mm I.D. SS	WA 201	22
9	LOCK WASHER 8mm I.D. SS	WA 205	4
10	Dealer Hardware Kit	KW HD 250	1
11	Dealer Trim Tab Hardware Kit	KW HD 255	1
12	LEFT SHIPPING SPACER	BK 553	1
13	RIGHT SHIPPING SPACER	BK 554	1
14	LIFTING PLATES	BK 502	2



# DEALER INSTALLATION - KENWORTH AIR FAIRING #KW AF 350 EXTENDED CAB VERSION

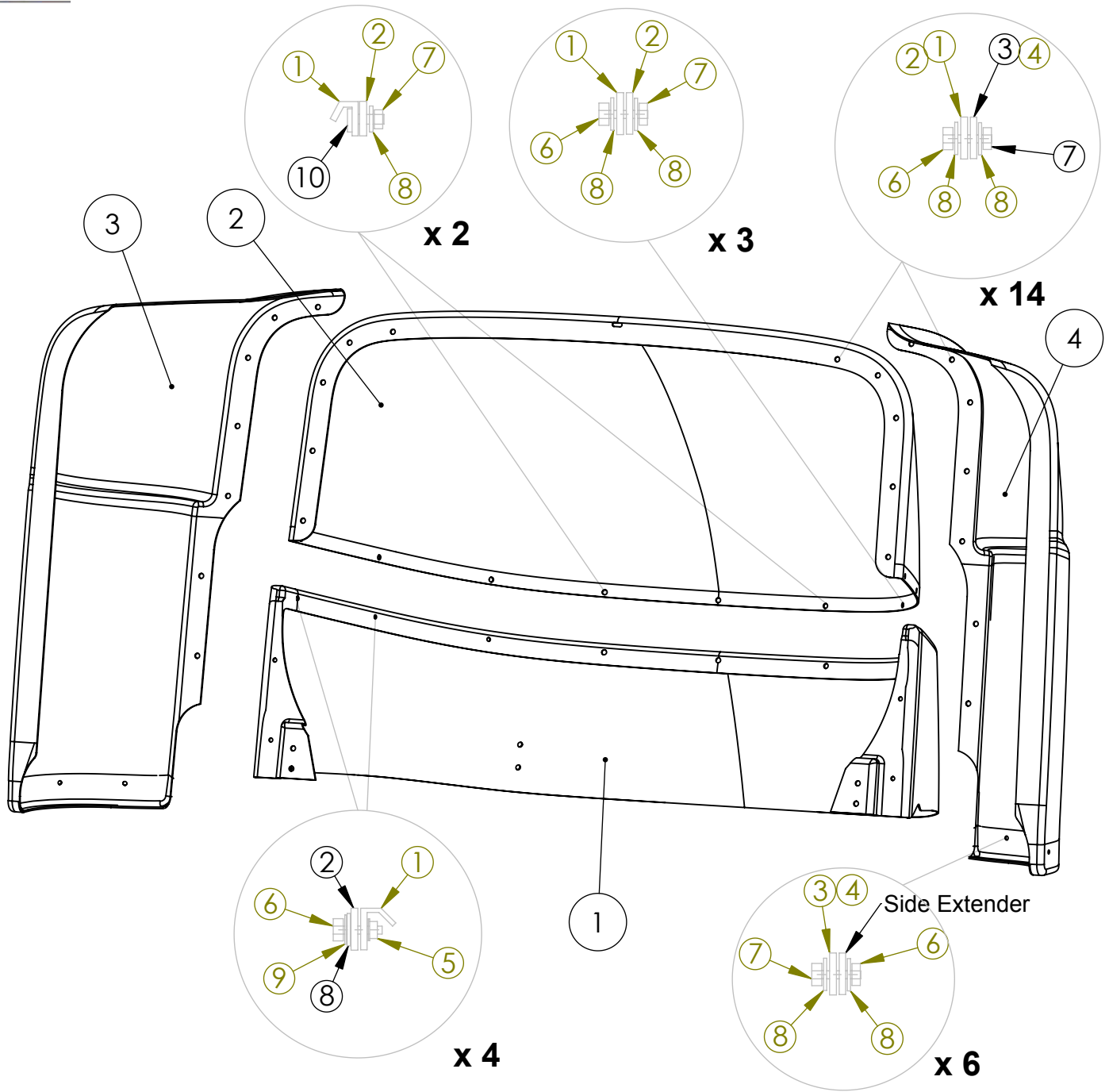

ITEM. NO:	DESCRIPTION	PART #	QTY
1	FAIRING BOTTOM (LOWER)	KW FB 250	1
2	FAIRING TOP (UPPER)	KW FT 200	1
3	LEFT TRIM TAB	KW TL 250	1
4	RIGHT TRIM TAB	KW TR 250	1
5	M8x1.25 AVK rivnut	RN 201	4
6	BOLT M8x1.25 x 25mm, SS Hex	SC 201	27
7	LOCKNUT M8x1.25, SS Hex	NU 201	25
8	FENDER WASHER 8mm I.D., SS	WA 201	52
9	LOCK WASHER, 8mm I.D., SS	WA 205	4
10	M8x1.25 x35mm stud plate	SP 200	2



# DEALER INSTALLATION - KENWORTH AIR FAIRING #KW AF 350 EXTENDED CAB VERSION

TRUCK MANUFACTURER: KENWORTH

SLEEPER/CAB SIZE: T800 / R33-1092(Extended)

KWPA 565

1. Remove shrink-wrap packaging. Remove trim tabs (Long versions only) from cavity of upper fairing.
2. Remove nylon insert nuts, flat washers and lift plates from the bottom fairing at the two permanent stud plates. KEEP all fasteners for reuse and discard the two lift plates.
3. Free the top from the two fiberglass shipping spacer brackets by removing corresponding fasteners. The one stud plate on the spacer bracket will prevent the front end of the top from dropping while holding the other end of the top. This will also free up the fastener bag. With the top removed, now remove the two fiberglass shipping spacer brackets by removing remaining fasteners attaching to the bottom. KEEP all fasteners for reuse and discard the two fiberglass shipping brackets.
4. Loosen (but do not remove) all fasteners attaching the bottom to the cab's rear roof brackets. This will assist alignment of air fairing components to each other and roof.
5. Invert upper fairing and align the two slotted holes of the upper fairing onto the two lower fairing stud plates. Install one M8x25mm hex bolt, M8 lock washer and M8 fender washer into the four M8 rivnuts located at the upper rear edge of the lower fairing. Do not tighten at this point.
6. Install one M8 locknut and M8 fender washer onto each stud plate, hand tight only.
7. Install one M8x25mm hex bolt, two M8 fender washers and one M8 locknut into the three remaining holes of the upper and lower fairing joint. Hand tighten only.
8. Install the left trim tab behind the side extender such that the smooth surface of the trim tab is touching the back of the side extender. Install one M8x25mm hex bolt, two M8 fender washers and one M8 locknut into each hole joining the trim tab to the upper and lower fairing. Do not tighten.
9. Repeat step 8 for the right trim tab.
10. With all fasteners loose align air fairing for best fit. Starting with the middle of the upper/lower fairing joint, tighten each bolt to 20 to 25ft.lbs of torque. Tighten each bolt working towards the rear of the fairing. Then tighten the remaining bolts of both trim tabs and rear mounting roof brackets.
11. Using the three holes in the lower left trim tab overlapping the left side extender as a template, drill 9.5mm holes through the side extender.
12. Install one M8x25mm hex bolt, two M8 fender washers and one M8 locknut into each hole in the left trim tab. Ensure lock nuts are on the inside. Tighten to 20 to 25 ft.lbs.
13. Repeat steps 11 and 12 for the right trim tab.
14. Now ensure all fastener connections are tightened.

## RECOMMENDED TORQUE SPECS

BOLT SIZE	TORQUE [ft.lbs]	
	MIN	MAX
1/4" BOLTS	10	15
5/16" BOLTS	20	25
M8 BOLTS	20	25
3/8" BOLTS	30	35

## ORDERING AND CUSTOMER SUPPORT:

Laydon Composites Ltd. TEL: 905-829-9200

2109 Wyecroft Road FAX: 905-829-9701

Oakville, ON, L6L 5L7 Canada